

How to Make a DIY Picture Frame Ledge

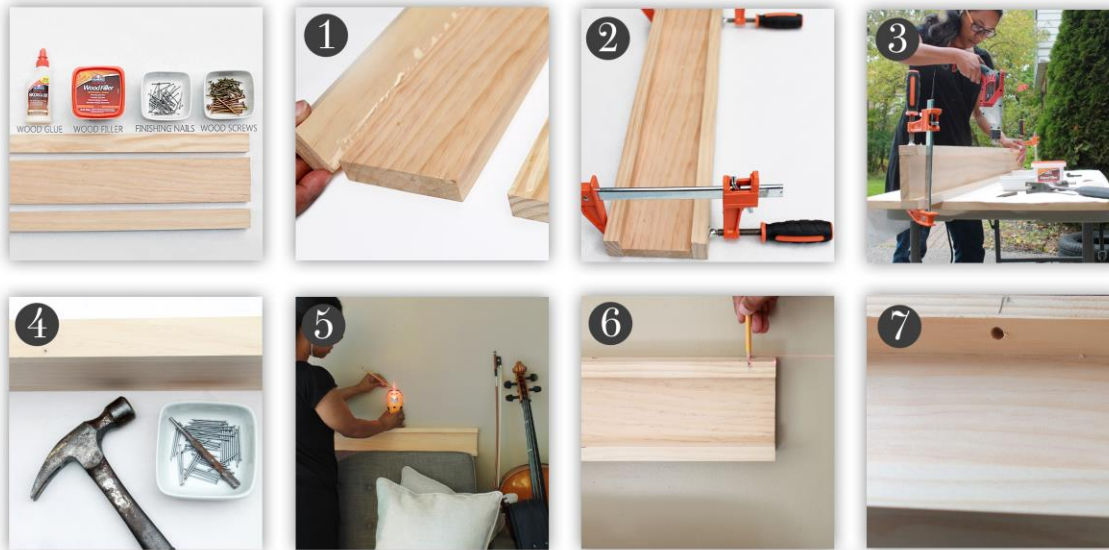

SHOPPING LIST:

1x2 -6ft Select Pine Board (2)
1x4 -6ft Common Board
Finishing nails
2" Gold Screws
3" Gold Screws (optional)
Elmer's Carpenter's® Interior Wood Glue
Elmer's Carpenter's® Color Change Wood Filler
Paint or stain of choice (optional)



- 1 Glue two side ledges to the base
- 2 Clamp in place. Set up workspace so the clamps can overhang, and the ledge can be set upright
- 3 Screw down the back ledge to the base. Drill pilot holes and countersink screws
- 4 Hammer down the front ledge to the base. Countersink finishing nails and cover with wood filler
- 5 Find and mark studs in the wall where the ledge will go
- 6 Transfer stud marks to the back side of the ledge
- 7 Drill holes through the back of ledge where stud marks indicate. Paint or stain, then once dry secure to the wall and enjoy!

for more details on this project go to:

www.HomeMadebyCarmona.com/diy-picture-frame-ledge/